

# 12 VOLT HIGH PERFORMANCE PUMPS

## HIGH-FLO 4.5 G.P.M. HIGH PERFORMANCE



**2 YEAR  
WARRANTY**

- 4.5 GPM High Performance 12 Volt Pump
- 60 PSI Max Pressure
- Increased Flow Rates
- In-Line Fuse Protection
- 12 Volt Dc Power
- Self Priming - 8 Ft To 14 Ft
- Runs Dry Without Damage
- Chemical Resistant Elastomers
- Quick Attach Pdrts
- Fan Cooled Motor

- DEMAND SWITCH MODELS operate only when liquid flow is required. Pump and motor stop instantly when discharge is closed.
- Diaphragm design eliminates troublesome shaft seal.
- Pump can be run indefinitely without damage.

- Ball bearing drive - assures longer pump life.
- Excellent self-priming capability.
- Santoprene diaphragms and viton valves are standard.
- Maximum temperature of pumped liquid 130°F.
- Permanent magnet motor - long life brushes.

- Fuse Protected
- Built-In cooling fan

Boxed Part #	Individual Part #	Volts	Amps	Demand Switch or Relief Valve	Max Pressure	GPM	UPC Code
5151088	5281372	12	11.0	Demand Switch	60	4.5	733029118080 (Boxed)

**STOP WARNING STOP**  
DO NOT USE PUMP IN AN EXPLOSIVE ENVIRONMENT. DO NOT USE TO PUMP FLAMMABLE/COMBUSTIBLE FLUIDS, GASOLINE, KEROSENE, FUEL, OIL, ETC.

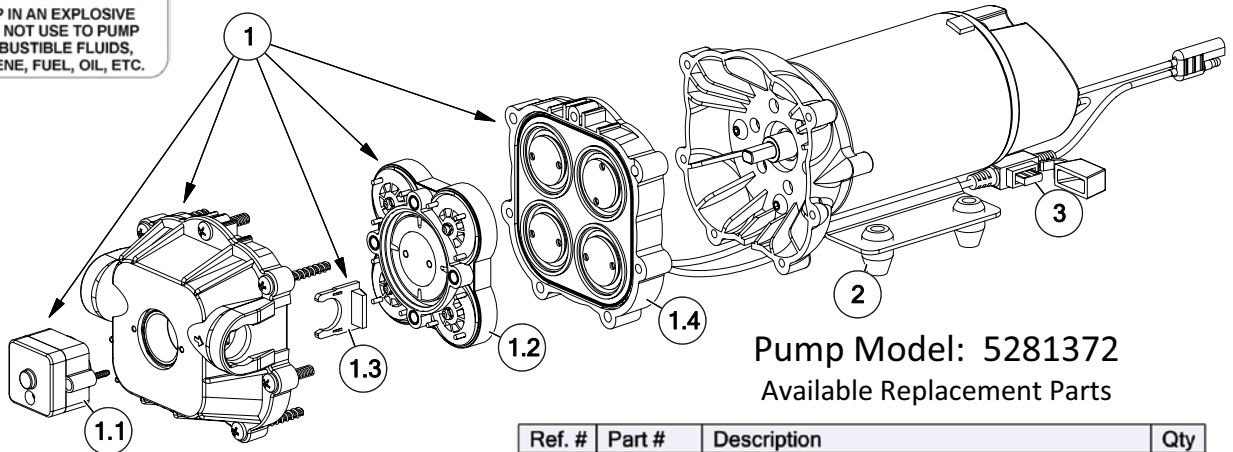

Pump Model: 5281372  
Available Replacement Parts

### Replacement Pump: 5151088

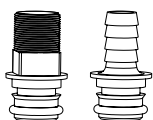

- Includes:  
1/2" MNPT Port Kit Fitting #5168832  
1/2" Hose Barb Port Kit Fitting #5168833

Ref. #	Part #	Description	Qty
1	5151097	4.5 GPM Pump Head	1
1.1	5164271	60 PSI Pressure Switch	1
1.2	5168824	Check Valve w/O-Ring	1
1.3	5051162	Pump Slide Clips (Pkg/2)	1
1.4	5063271	4.5 GPM Diaphragm/Piston/Cam/Bearing Kit	1
2	5075019	Grommets (Pkg/4)	1
3	5157206	15 Amp 'Mini Blade' Fuse	1